

Planboard: Split Large Orders into Multiple Smaller Orders

Last updated by | David Mishler Gomocha | May 6, 2025 at 2:48 PM GMT+2

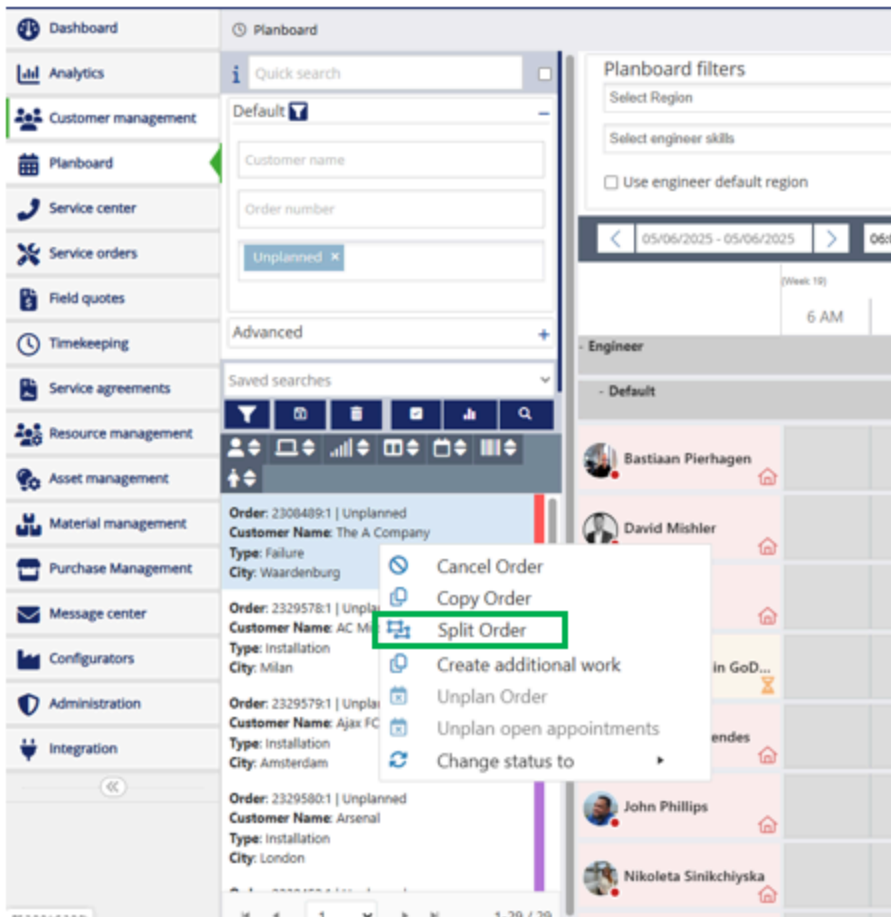

Split Large Orders into Multiple Smaller Orders



Developer Notes:

- Work orders which are equal or smaller than the max split size, are not updated by FMP360.
- Last order contains the remaining hours, egx when a order of 82 hours is split in pieces of 10 hours, the last sub is an order of 2 hours.
- Original order (sub 1) is also resized, like the other newly formed sub orders
- Split work orders can be planned in easily with existing functionality, by selecting a set of work order in FMP360 and drag them to the Gantt

Use Case:

- Large installation jobs are interfaced in the form of a single work order the size of for example 80 hours.
- In FMP360, orders like this should be broken up into smaller (configurable) pieces, like 8 or 10 hours (or 4 hours, so possible to set the duration to split to).
- The result is that there are now work orders in FMP360 which can easily be planned to different engineers on different dates.

Configuration:

Master Data: Activity Type

Master Data > Activity Type > Split Activity Allowed box checked

The screenshot displays the 'Master data manage' interface. On the left, a table lists activity types with columns for 'id', 'Description', and 'Billable'. The 'Installation' activity type is highlighted. On the right, the configuration form for the 'Installation' activity type is shown. The 'Splitactivity_allowed' checkbox is checked, and the 'is project' checkbox is also checked. Other configuration options include 'Duration' (240), 'Response time' (7200), 'Flow definition' (Installation), and 'Finishing factor' (Default finishing factor).

id	Description	Billable
Maintenance	Maintenance	1
Failure	Failure	1
Installation	Installation	1
Meeting	Meeting	0
Lunch	Lunch	0
TravelHome	Travel home	0
Test Activity	Test Activity	0
Preventative Maintenance	Preventative Maintenance	1

Planboard (After order is created)

Order Search > Right Click on Order > Select 'Split Order' option

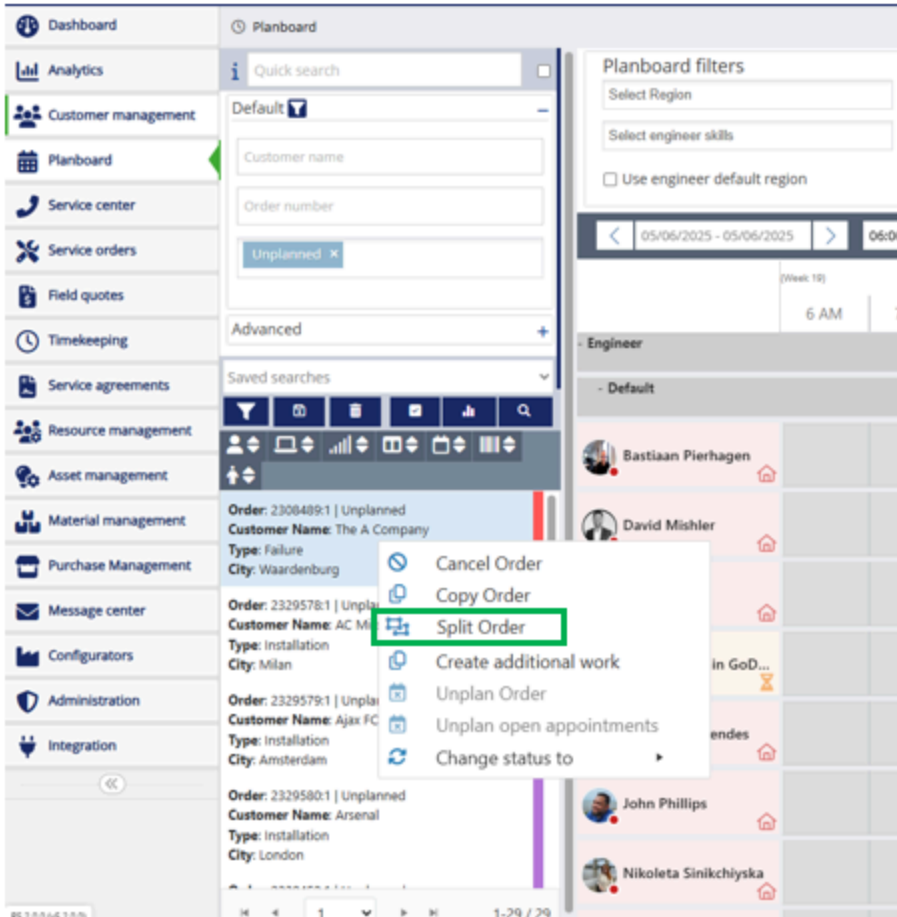

Split Order Screen:

- Materials and attachments from planning are visible
- **Duration**= length of order
- **Number of orders** = number of orders original order will be split in to
- **Duration per order** = how long each new order will be

SPLIT ORDER: #2482020 : 1

Material									
<input checked="" type="checkbox"/>	Type	Article number	Article descri...	Quantity	Unit	Serial number	From wareho...	To warehouse	Notes

Duration: 12

Number of orders:

Duration per order:

SPLIT

Attachments from planning	
<input checked="" type="checkbox"/>	File name

Example:

- Duration of order is 12 hours
- Number of orders is split into 3
- Duration of each order is 3 hours
- Hours left from original order needed to be assigned is 0
- When finished select '**Split**'

Duration: 12

Number of orders:

3

Duration per order:

4

Hours Left: 0

SPLIT

Order Confirmation

- Confirm order split

Order: #2482020:1 ?

Order Registrations Customer Questionnaire Status history

Order Data 2482020:1

Assets Dishwasher 10 ParksonAdminFae0ba19433464388e40e9a333820b4

Status Unplanned

Customer Gomocho

Reported time 5/6/2025, 2:38 PM

Type* Maintenance

Priority -

Skills Select Some Options

Status date and time 5/6/2025, 2:39 PM

Characteristics Select Some Options

Project Number

Name

Remark Paragraph

Address and contact data

Street a

House number addition

City a

Zip Code a

Region* Default

Country Nederland

State

Additional Address Info

Latitude 52.132633

Longitude 5.291265999999999

SELECT LOCATION

Order Planning

Asset number* a

Maintenance Data* a

Engineer group

Override auto-added skills

Engineers

Default warehouse for engineer

Appointment Fixed?

Engineer Fixed?

Scheduled start date & time 5/6/2025, 2:43 PM

Scheduled end date & time 5/6/2025, 6:43 PM

Duration 000.04.00

SLA start date & time 5/6/2025, 2:43 PM

SLA end date & time 5/11/2025, 2:43 PM

SLA duration 005.00.00

Preferred engineer

Problem

Cause

CANCEL SAVE AND SAVE AND PLAN SAVE

Planboard

- Order search now reflects the 'Split' work order based on the number of orders that were input on the split order screen

- Material and Attachments will be carried over to all new orders
- Orders can now be planned

Saved searches

Order: 2482020:1 | Unplanned
Customer Name: Gomocha
Type: Maintenance
City: a

Order: 2482020:2 | Created
Customer Name: Gomocha
Type: Maintenance
City: a

Order: 2482020:3 | Created
Customer Name: Gomocha
Type: Maintenance
City: a

Note: Orders can also be split from the order registration screen > same process follows

Order: #2482020:1 ?

Order Registrations Customer Questionnaire Status history

Order Data	Address and contact data	Order Planning
Order Number: 2482020 : 1	Street: a	Asset number: a
Assets: Dishwasher 10 ParksonAdminf9ae6ba19433464388e40e8a333820b4	House Number- House number addition: a	Maintenance Data: a
Status: Unplanned	City: a	Engineer group: -
Customer: Gomocha	Zip Code: a	Override auto-added skills: No
Reported time: 5/6/2025, 2:38 PM	Region: Default	Engineers: -
Type: Maintenance	Country: Nederland	Default warehouse for engineer: -
Priority: -	State: -	Appointment Fixed?: No
Skills: -	Additional Address info: -	Engineer Fixed?: No
Status date and time: 5/6/2025, 2:39 PM	Latitude: 52.132633	Scheduled start date & time: 5/6/2025, 2:43 PM
Characteristics: -	Longitude: 5.291265999999999	Scheduled end date & time: 5/6/2025, 6:43 PM
Project Number: -		Duration: 000.04:00
Name: -		SLA start date & time: 5/6/2025, 2:43 PM
Remark: -		SLA end date & time: 5/11/2025, 2:43 PM
		SLA duration: 005.00:00
		Preferred engineer: -
		Problem: -
		Cause: -
		Solution: -

Internal remark

CHANGE STATUS TO ▲

ORDERS NEARBY COPY SPLIT